

ELEVATION

SCALE: 1" = 1'-0"

NOTES:

- MEMBERS SHALL BE RECYCLED STRUCTURAL PLASTIC LUMBER, TRIMAX STRUCTURAL LUMBER BY TRIMAX BUILDING PRODUCTS; OR APPROVED EQUAL.
- PLASTIC LUMBER DIMENSIONS ARE NOMINAL SIZES.
- STAINLESS STEEL ANCHORS SHALL BE FABRICATED FROM 2205 DUPLEX GRADE ALLOY.
- CONTRACTOR HAS OPTION TO INSTALL ADDITIONAL S.S. ADHESIVE ANCHORS THROUGH 4x6 BACKING MEMBERS TO AID IN ERECTION. ANCHORS SHALL NOT CONFLICT WITH EACH OTHER.
- STAGGER JOINTS IN HORIZ. FENDERS. FENDERS SHALL BE CONTINUOUS OVER A MIN. OF 3 VERT. BACKING SUPPORTS.
- COUNTERSUNK END OF THREADED ROD/NUT SHALL BE 1/4" MIN. TO 1/2" MAX. BELOW FACE OF FENDER.
- PLASTIC LUMBER FENDER COLORS: BLACK OR GREY.

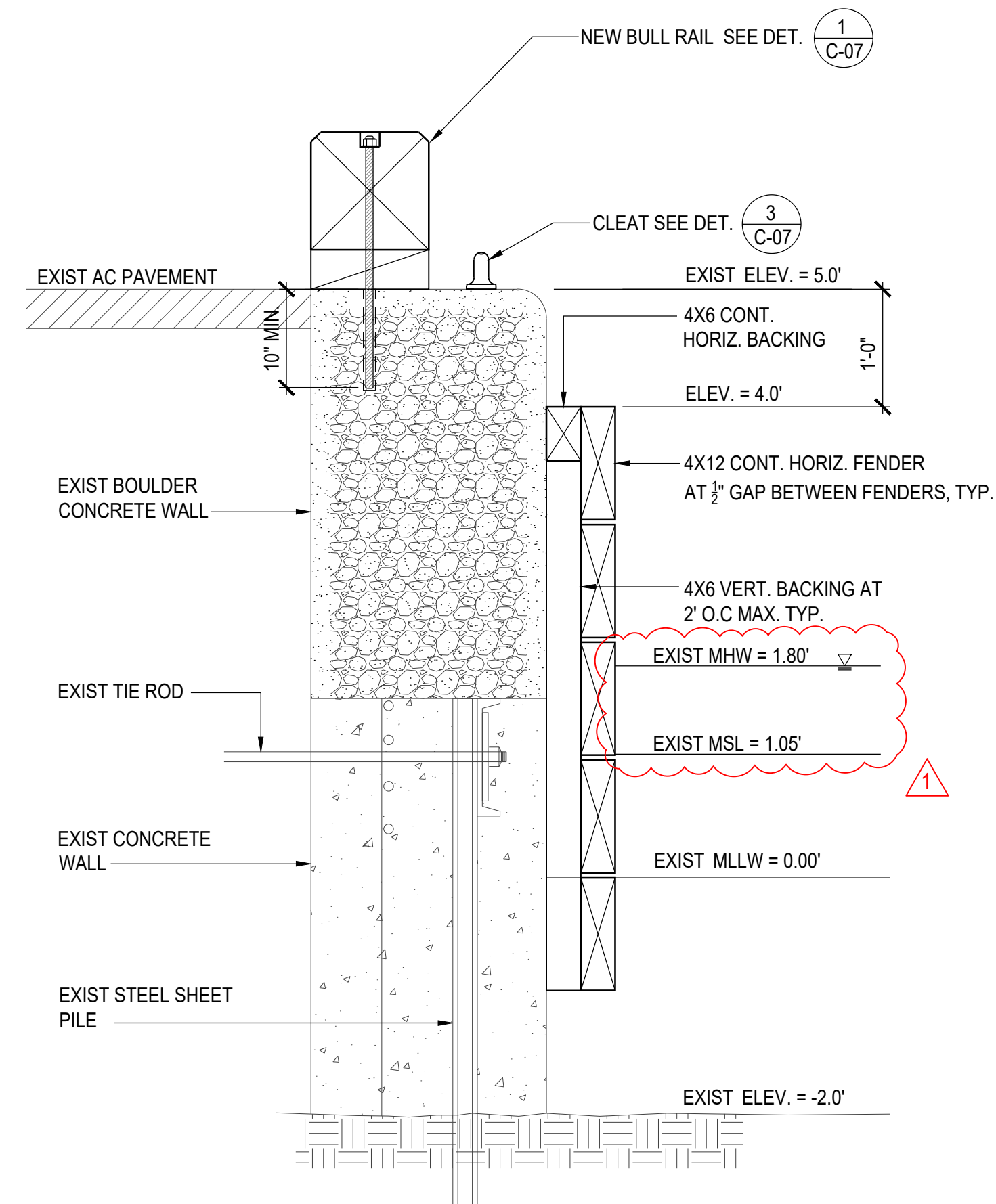

1

SECTION

SCALE: 1" = 1'-0"

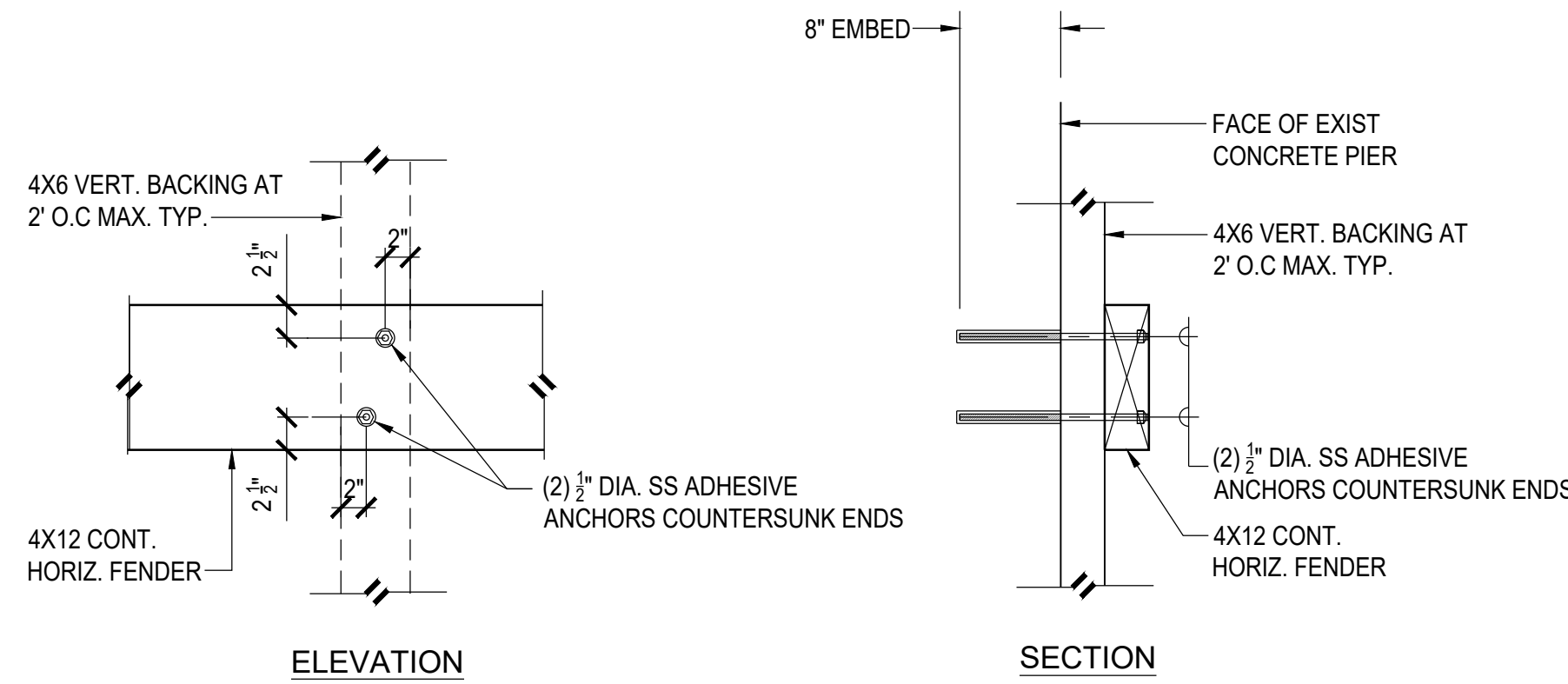

ELEVATION

SECTION

2

CONNECTION DETAIL

SCALE: 1" = 1'-0"

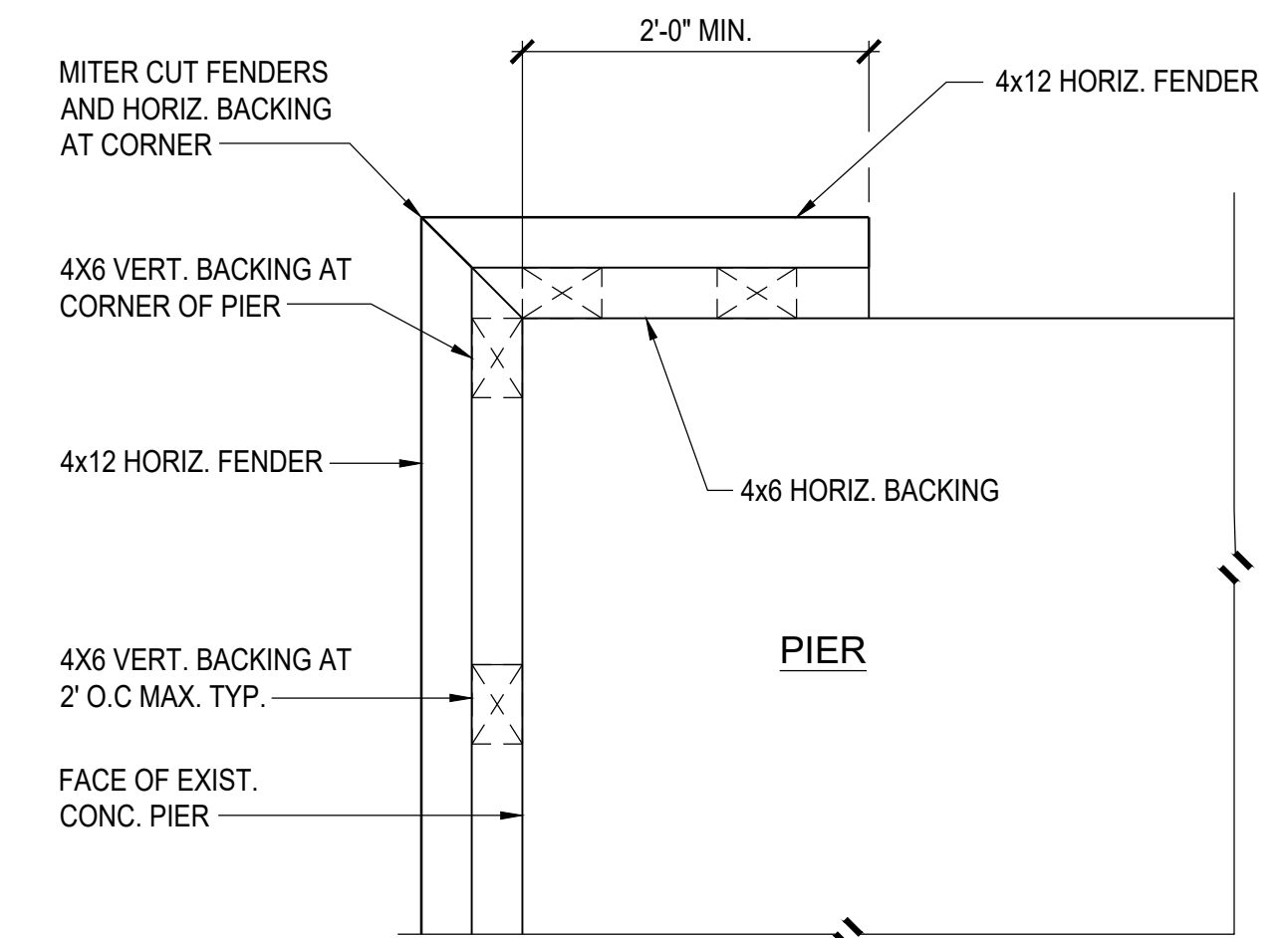

4

OUTSIDE CORNER DETAIL (EAST)

SCALE: 1" = 1'-0"

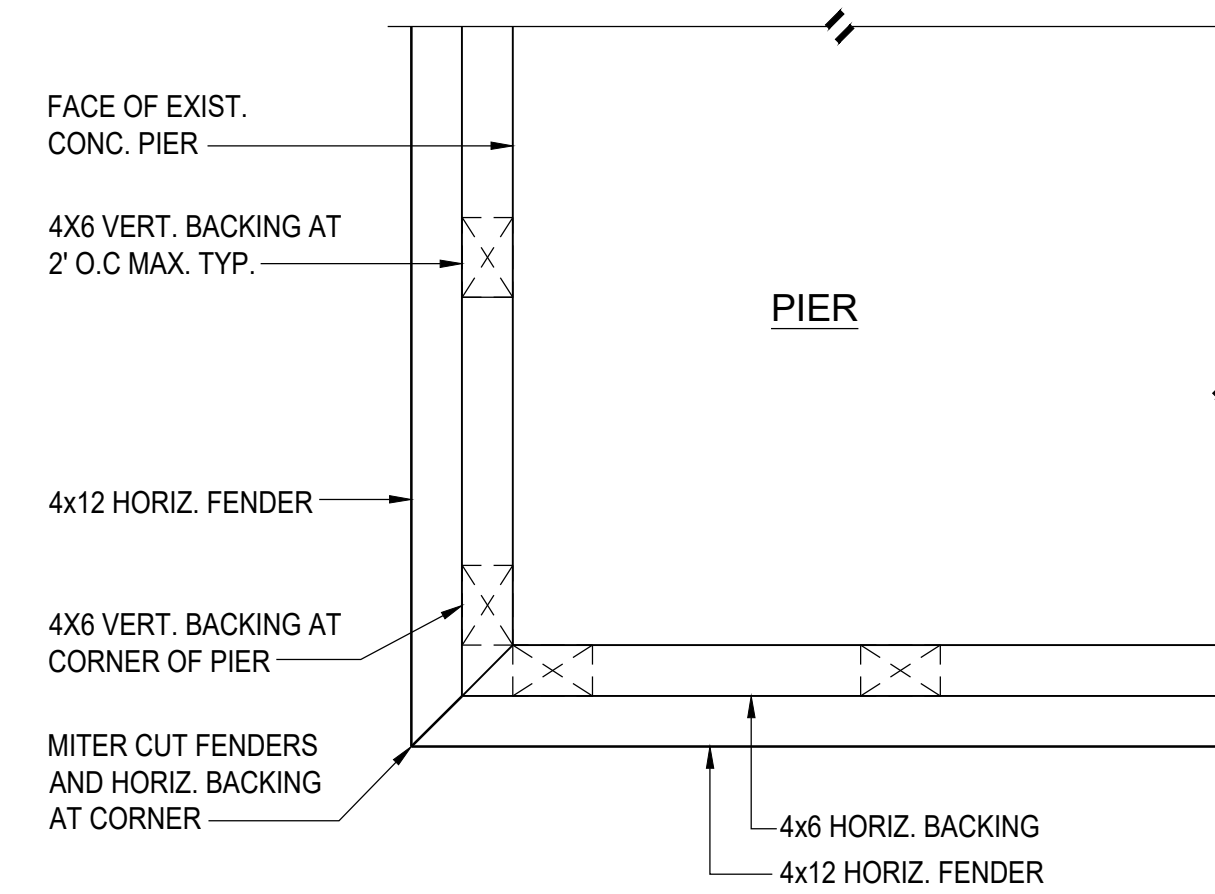

3

OUTSIDE CORNER DETAIL (WEST)

SCALE: 1" = 1'-0"

REVISION NO.	DESCRIPTION	DATE
1	ADDENDUM NO. 1	05/22/2026

	STATE OF HAWAII DEPARTMENT OF LAND AND NATURAL RESOURCES DIVISION OF BOATING AND OCEAN RECREATION	
	HEEIA KEA SMALL BOAT HARBOR BULKHEAD FENDER REPAIRS KANEHOE, OAHU, HAWAII JOB NO. B78C071A	
SHEET TITLE FENDER DETAILS		
DESIGNED BY: SQ, DR	SUBMITTED: 4/21/2026	
DRAWN BY: GP, SQ	DATE: 4/21/2026	
CHECKED BY: DR	SCALE: -	
THIS WORK WAS PREPARED BY ME OR UNDER MY SUPERVISION <i>Donald K. Reilly</i> EXPIRATION DATE OF THE LICENSE 4/30/2028	DRAWING NO. C-06	